

EDUR[®]

BC

Stainless Steel In-Line Centrifuge Pumps

**Shanley Pump
& Equipment, Inc.**

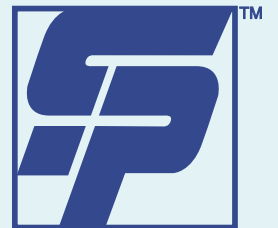

BC



Features

The EDUR BC Stainless Steel Centrifugal Process Pump are all-purpose standard circulation pumps for clear or slightly polluted liquid mediums with a wide range of applications. The EDUR BC Pumps design allows it to fit easily into the standard footprint of a more traditional stainless steel centrifugal pump.

Description

The EDUR BC Series Stainless Steel Centrifugal Process Pump is made of Stainless Steel for superior strength characteristics and is available for immediate delivery from Shanley Pump and Equipment, Inc.

The BC series is designed with a standard closed impeller design with single or double acting mechanical seals for durability and long-lasting performance. The BC Series is also available in a custom flanged centrifugal pump for tank installation for versatility.

The EDUR BC Series Stainless Steel Centrifugal Process Pump Series operates at pressures up to 115 PSI at a temperature range of -13°F to +230°F with a Viscosity of 115 mm²/s with a series maximum flow rate of 44 GPM.



Shanley Pump & Equipment, Inc.
2525 S. Clearbrook Drive
Arlington Heights, IL 60005
P: 847.439.9200
F: 847.439.9388
www.shanleypump.com
sales@shanleypump.com

Usage

Being designed in Stainless Steel has its advantages for performance that traditional steel cannot offer. The BC Series can be utilized in the food industry with CIP (Clean In Place) connections and its easy to maintain pull-back design. More traditional uses of a stainless steel centrifugal pump such as cooling and refrigeration, shipbuilding, energy production, filtration, and apparatus engineering are easily handled by the EDUR BC's design.

Main Applications

- Refrigeration Industry
- Ship Building Industry
- Filtration Applications
- Cooling Applications
- Clear Liquids
- Slightly Polluted Liquids
- CIP (Clean In Place)
- Hot/Cold Water Pumping
- Recirculation Systems

GPM Up to 44 GPM

PSI 0 - 115 PSI

TEMP -13°F - +230°F

HEAD 236 ft.

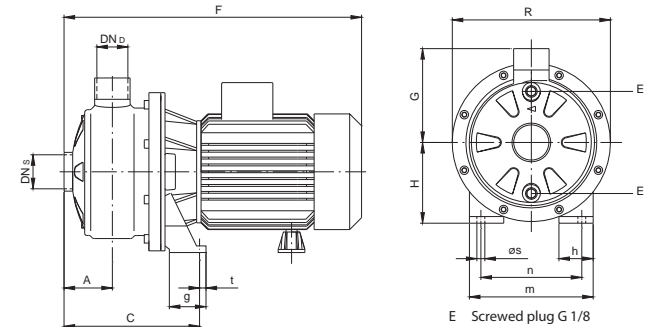

Dimensions Drawings

[Click here for complete dimensional drawings](#)



60Hz
Performance Curve

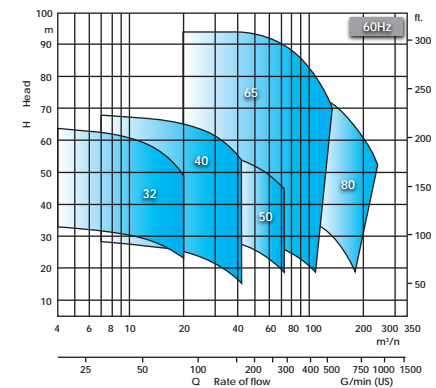

50Hz
Performance Curve

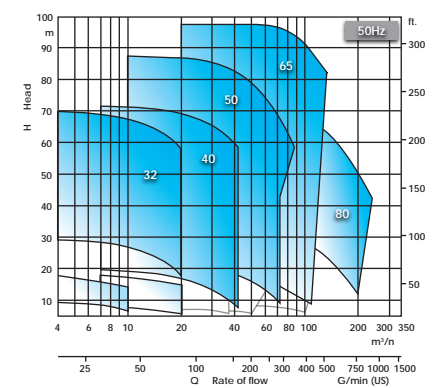

[Click here for complete Flow Curves](#)