

Flange dimensions EN 1092-2

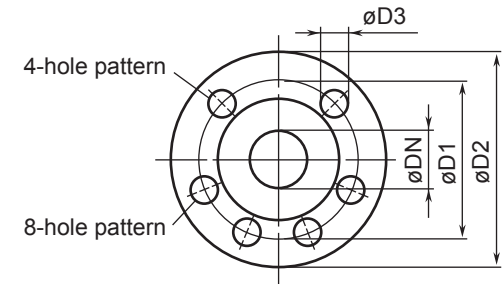

TOE-MA Pump Model	Flanges		Dimensions of pump									Pull-Out x	
	DNS	DND	a	bL	bR	h1	h2	b	m1	m2	n1		n2
32-160	2	1.25	3.15	4.84	4.84	5.20	6.30	1.97	3.94	2.76	9.45	7.48	4.33
32-200	2	1.25	3.15	4.84	5.32	6.30	7.09	1.97	3.94	2.76	9.45	7.48	4.33
32-250	2	1.25	3.94	5.99	6.42	7.09	8.86	2.56	4.92	3.74	12.60	9.84	4.33
40-160	2.5	1.5	3.15	4.84	5.08	5.20	6.30	1.97	3.94	2.76	9.45	7.48	4.33
40-200	2.5	1.5	3.94	5	5.55	6.30	7.09	1.97	3.94	2.76	10.43	8.35	4.33
40-250	2.5	1.5	3.94	5.95	6.30	7.09	8.86	2.56	4.92	3.74	12.60	9.84	4.33
50-160	2.5	2	3.94	4.84	5.35	6.30	7.09	1.97	3.94	2.76	10.43	8.35	4.33
50-200	2.5	2	3.94	5.11	5.83	6.30	7.87	1.97	3.94	2.76	10.43	8.35	4.33
50-250	2.5	2	3.94	6.18	6.69	7.09	8.86	2.56	4.92	3.74	12.60	9.84	4.33
65-160	3.25	2.5	3.94	4.88	5.95	6.30	7.87	2.56	4.92	3.74	11.02	8.35	4.33
65-200	3.25	2.5	3.94	5.35	6.46	7.09	8.86	2.56	4.92	3.74	12.60	9.84	4.33
80-160	4	3.25	4.93	5.47	6.85	7.09	8.86	2.56	4.92	3.74	12.60	9.84	4.33

Flange dimensions in acc. with DIN EN 1092-2

ØDN	ØD2	ØD1	t	ØD3	# Holes
1.26	5.51	3.94	.71		
1.57	5.91	4.33	.71		
1.97	6.50	4.92	.79	.75	4
2.56	7.28	5.71	.79		
3.15	7.87	6.30	.87		
3.94	8.66	7.09	.95		8

Utility Connections

P1	Outlet pressure indicator connection (not drilled)	1/4 NPT
P2	Inlet pressure indicator connection (not drilled)	1/8 NPT
D1	Volute casing drain	3/8 NPT
T1	Temperature sensor PT 100 MK 110/135	1/4 NPT
T2	Temperature sensor PT 100 MK 75	1/4 NPT

Inches

**TOE-MA**

Heat Transfer Pump

Heat transfer pumps with bearing bracket and mechanical seal  
(all measurements are in inches)

Shanley Pump  
& Equipment, Inc.

