

OSNA

VKI

Vertical High Pressure Centrifugal Pump

Shanley Pump
& Equipment, Inc.



VKI

Features

The OSNA VKI Pumps performance is up to 484 GPM (Gallons per Minute) with fluids at temperatures up to 248°F at 435 PSI with 964 Ft. of Head as well as the OSNA VKI series of High Pressure Non Self-Priming Centrifugal Circulation Pumps are either furnished with mechanical seals.

The unique design of the CVP allows for 3 Hydraulic sizes to be available in one casing size as well as a variable flange position. Lubrication for the bearings is provided by the liquid being pumped.

Description

The OSNA VKI (Vertical) Series of Vertical Inline High Pressure Multistage Centrifugal Irrigation Pumps are high-efficiency liquids pumps that are designed for low noise and high strength in addition to their superior pumping performance as well as a vertical mounting for locations with limited space for a horizontal mounted pump.

The OSNA VKI (Vertical) Series of High Pressure Vertical Inline Centrifugal Pumps capabilities lie in the pumping of clear and slightly contaminated liquids in pressure boosting systems sets. These Liquids include Fresh water from wells for irrigation plants or for water supply and hot and cold water circulation.







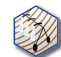

Shanley Pump & Equipment, Inc.
 2525 S. Clearbrook Drive
 Arlington Heights, IL 60005
P: 847.439.9200
F: 847.439.9388
www.shanleypump.com
sales@shanleypump.com

Usage

The OSNA VKI Series will also perform well as a boiler feed pump or in a boiler feed system. Maintenance is easy for the VKI series with its Modular construction. The OSNA VKI Series is available in stainless steel for added strength.

Main Applications

-  Irrigation Systems Pumping
-  Slightly Polluted Liquids Pumping
-  Clear Liquids Pumping
-  Process Technology Pumping
-  High-Pressure Applications
-  Recirculation System Applications
-  Boiler Feed Applications

GPM up to 484 GPM

PSI 435 PSI

TEMP +248°F

HEAD 964 ft.

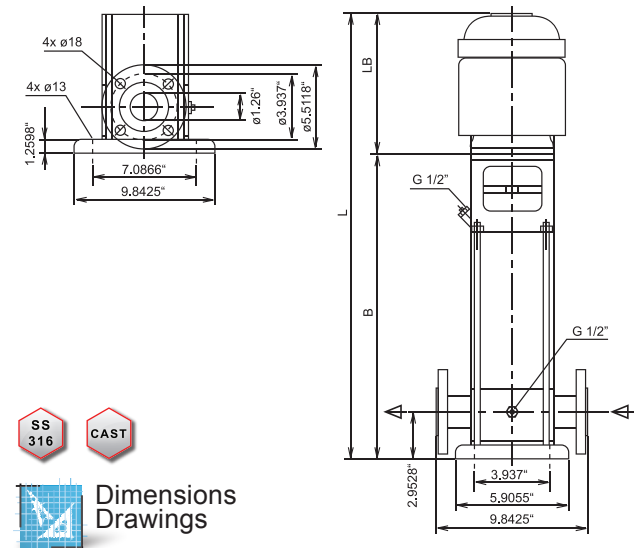

2900 RPM

50HZ
Performance Curve

